

**07 IBT**

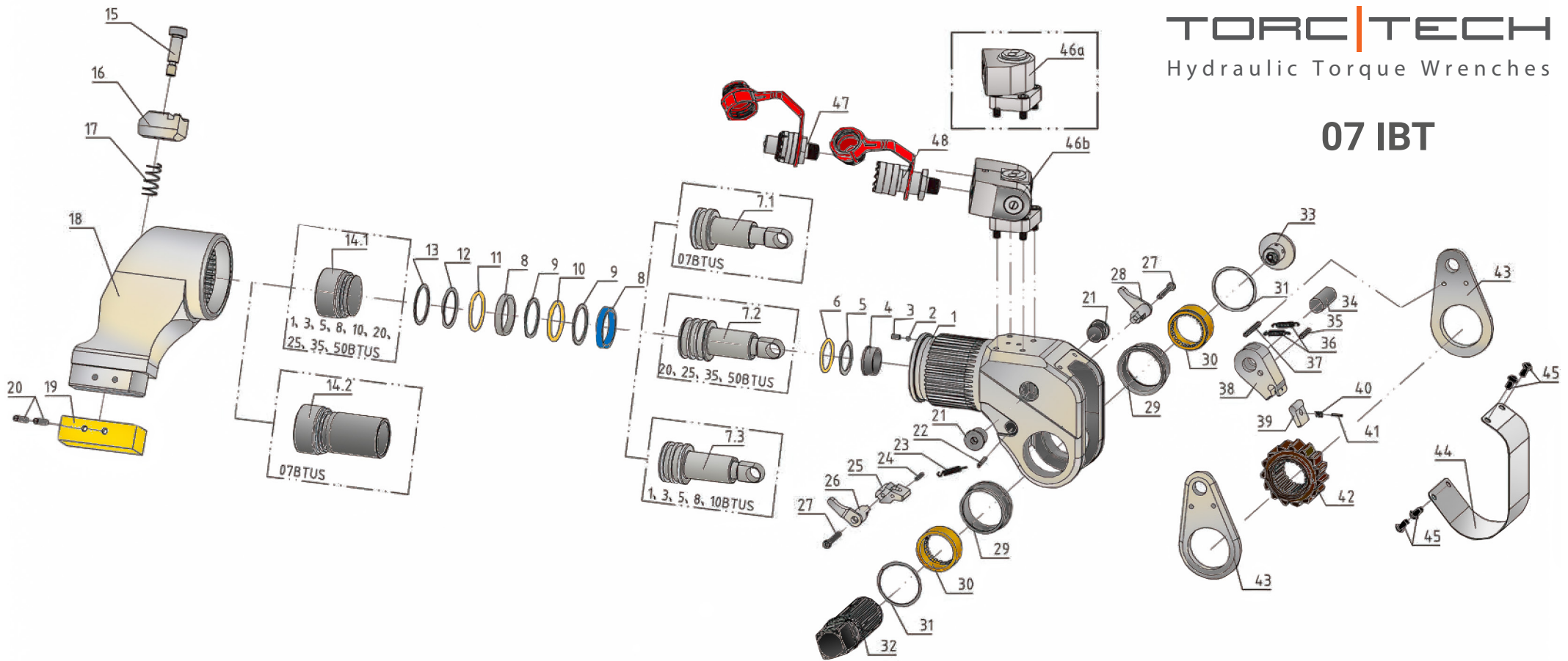

Part No	Description	Quantity
SP07M-01	BODY ASSEMBLY	1
SP07M-02	BALL	1
SP07M-03	SCREW M3	1
SP07M-07.1	PISTON ROD ASSEMBLY	1
SP07M-14.2	END CAP	1
SP07M-15	SCREW	1
SP07M-16	REACTION ARM FIXER	1
SP07M-17	SPRING	1
SP07M-18	REACTION ARM	1
SP07M-19	REACTION ARM COVER	1
SP07M-20	PIN	2
SP07M-21	BODY PLUG	2
SP07M-22	PIN	1

Part No	Description	Quantity
SP07M-23	SPRING	1
SP07M-24	PIN	1
SP07M-25	REACTION PAWL	1
SP07M-26	BUTTON LEVER(RIGHT)	1
SP07M-27	SCREW	2
SP07M-28	BUTTON LEVER(LEFT)	1
SP07M-30	DRIVE SLEEVE SPLINE	2
SP07M-31	CIRCLIP	2
SP07M-32	1" INC SQUARE DRIVE	1
SP07M-32a	3/4" INCH SQUARE DRIVE	1
SP07M-32b	17 mm ALLEN DRIVE	1
SP07M-33	DRIVE RETAINER	1
SP07M-34	ROD END PIN	1

Part No	Description	Quantity
SP07M-35	PIN FOR DRIVE PAWL	1
SP07M-36	SPRING	2
SP07M-37	PIN FOR DRIVE PLATE	1
SP07M-38	DRIVE PAWL ASSEMBLY	1
SP07M-42	RATCHET SPLINE	1
SP07M-43	DRIVE PLATE	2
SP07M-44	SHROUD	1
SP07M-45	SCREW	4
SP07M-46a	MULTISWIVEL ASSEMBLY [360°]	1
SP07M-46b	MULTISWIVEL ASSEMBLY [360°x180°]	1
SP07IBT-BSK	BODY SEAL KIT [8,9,10,11,12,13]	1
SP07IBT-SSK	SWIVEL SEAL KIT	1