

10 IBT

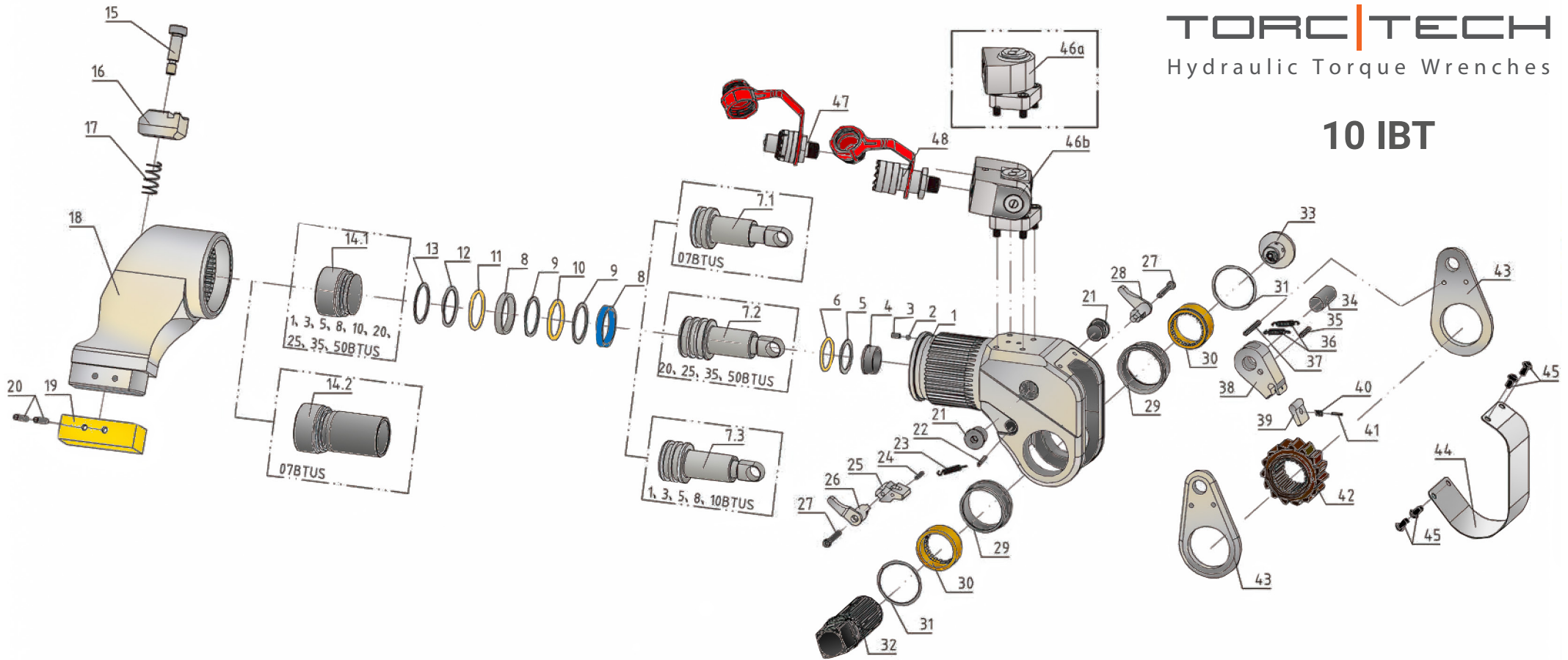

Part No	Description	Quantity
SP10M-01	BODY ASSEMBLY	1
SP10M-02	BALL	1
SP10M-03	SCREW M3	1
SP10M-07.3	PISTON ROD ASSEMBLY	1
SP10M-14.1	END CAP	1
SP10M-15	SCREW	1
SP10M-16	REACTION ARM FIXER	1
SP10M-17	SPRING	1
SP10M-18	REACTION ARM	1
SP10M-19	REACTION ARM COVER	1
SP10M-20	PIN	2
SP10M-21	BODY PLUG	2
SP10M-22	PIN	1

Part No	Description	Quantity
SP10M-23	SPRING	1
SP10M-24	PIN	1
SP10M-25	REACTION PAWL	1
SP10M-26	BUTTON LEVER(RIGHT)	1
SP10M-27	SCREW	2
SP10M-28	BUTTON LEVER(LEFT)	1
SP10M-30	DRIVE SLEEVE SPLINE	2
SP10M-31	CIRCLIP	2
SP10M-32	1.1/2" INC SQUARE DRIVE	1
SP10M-32a	32 mm ALLEN DRIVE	1
SP10M-33	DRIVE RETAINER	1
SP10M-34	ROD END PIN	1
SP10M-35	PIN FOR DRIVE PAWL	1

Part No	Description	Quantity
SP10M-36	SPRING	2
SP10M-37	PIN FOR DRIVE PLATE	1
SP10M-38	DRIVE PAWL ASSEMBLY	1
SP10M-42	RATCHET SPLINE	1
SP10M-43	DRIVE PLATE	2
SP10M-44	SHROUD	1
SP10M-45	SCREW	4
SP10M-46a	MULTISWIVEL ASSEMBLY [360°]	1
SP10M-46b	MULTISWIVEL ASSEMBLY [360°x180°]	1
SP10IBT-BSK	BODY SEAL KIT [8,9,10,11,12,13]	1
SP10IBT-SSK	SWIVEL SEAL KIT	1

A Brand of Surkon International