

20 IBT

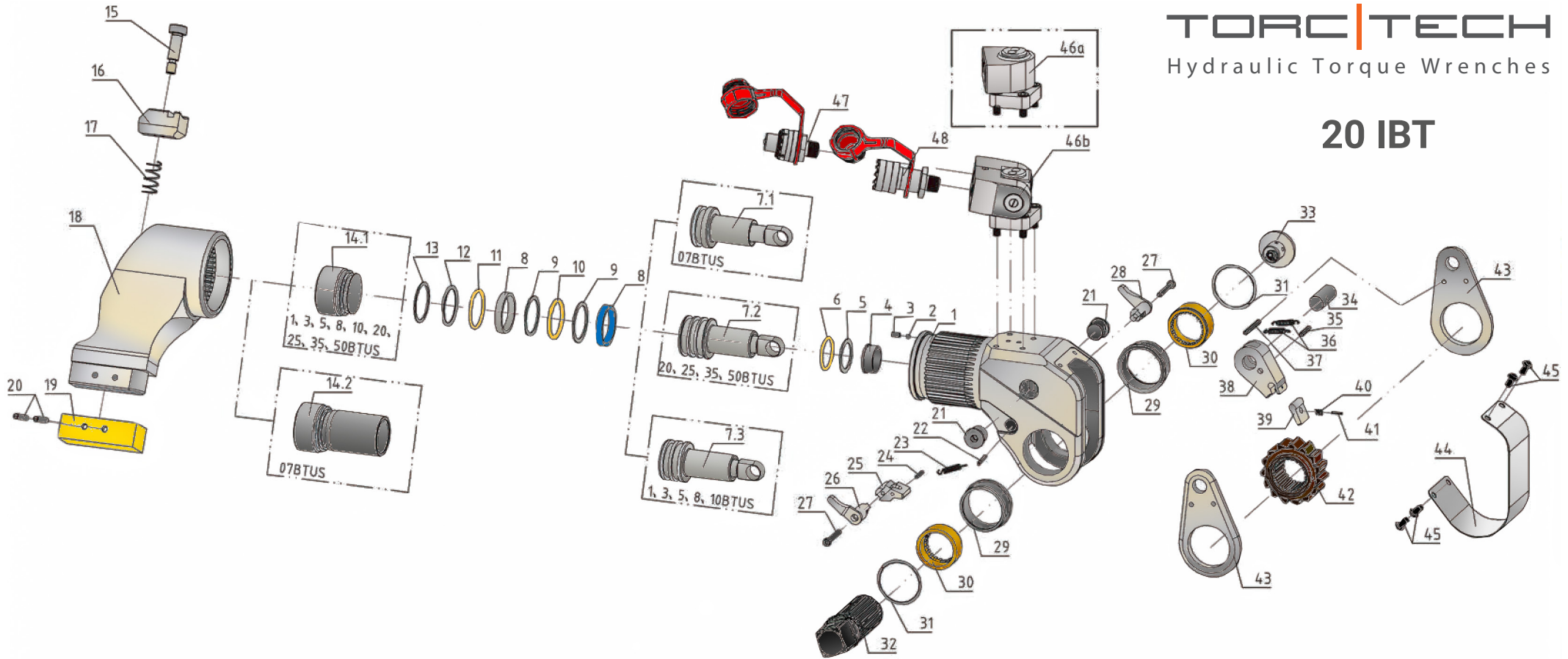

| Part No | Description | Quantity |
|------------|---------------------|----------|
| SP20M-01 | BODY ASSEMBLY | 1 |
| SP20M-02 | BALL | 1 |
| SP20M-03 | SCREW M3 | 1 |
| SP20M-07.2 | PISTON ROD ASSEMBLY | 1 |
| SP20M-14.1 | END CAP | 1 |
| SP20M-15 | SCREW | 1 |
| SP20M-16 | REACTION ARM FIXER | 1 |
| SP20M-17 | SPRING | 1 |
| SP20M-18 | REACTION ARM | 1 |
| SP20M-19 | REACTION ARM COVER | 1 |
| SP20M-20 | PIN | 2 |
| SP20M-21 | BODY PLUG | 2 |
| SP20M-22 | PIN | 1 |

| Part No | Description | Quantity |
|-----------|-------------------------|----------|
| SP20M-23 | SPRING | 1 |
| SP20M-24 | PIN | 1 |
| SP20M-25 | REACTION PAWL | 1 |
| SP20M-26 | BUTTON LEVER(RIGHT) | 1 |
| SP20M-27 | SCREW | 2 |
| SP20M-28 | BUTTON LEVER(LEFT) | 1 |
| SP20M-30 | DRIVE SLEEVE SPLINE | 2 |
| SP20M-31 | CIRCLIP | 2 |
| SP20M-32 | 2.1/2" INC SQUARE DRIVE | 1 |
| SP20M-32a | 41 mm ALLEN DRIVE | 1 |
| SP20M-33 | DRIVE RETAINER | 1 |
| SP20M-34 | ROD END PIN | 1 |
| SP20M-35 | PIN FOR DRIVE PAWL | 1 |

| Part No | Description | Quantity |
|-------------|----------------------------------|----------|
| SP20M-36 | SPRING | 2 |
| SP20M-37 | PIN FOR DRIVE PLATE | 1 |
| SP20M-38 | DRIVE PAWL ASSEMBLY | 1 |
| SP20M-42 | RATCHET SPLINE | 1 |
| SP20M-43 | DRIVE PLATE | 2 |
| SP20M-44 | SHROUD | 1 |
| SP20M-45 | SCREW | 4 |
| SP20M-46a | MULTISWIVEL ASSEMBLY [360°] | 1 |
| SP20M-46b | MULTISWIVEL ASSEMBLY [360°x180°] | 1 |
| SP20IBT-BSK | BODY SEAL KIT [8,9,10,11,12,13] | 1 |
| SP20IBT-SSK | SWIVEL SEAL KIT | 1 |

ISO 9001:2015 DS:IBT-SP1124-EN